

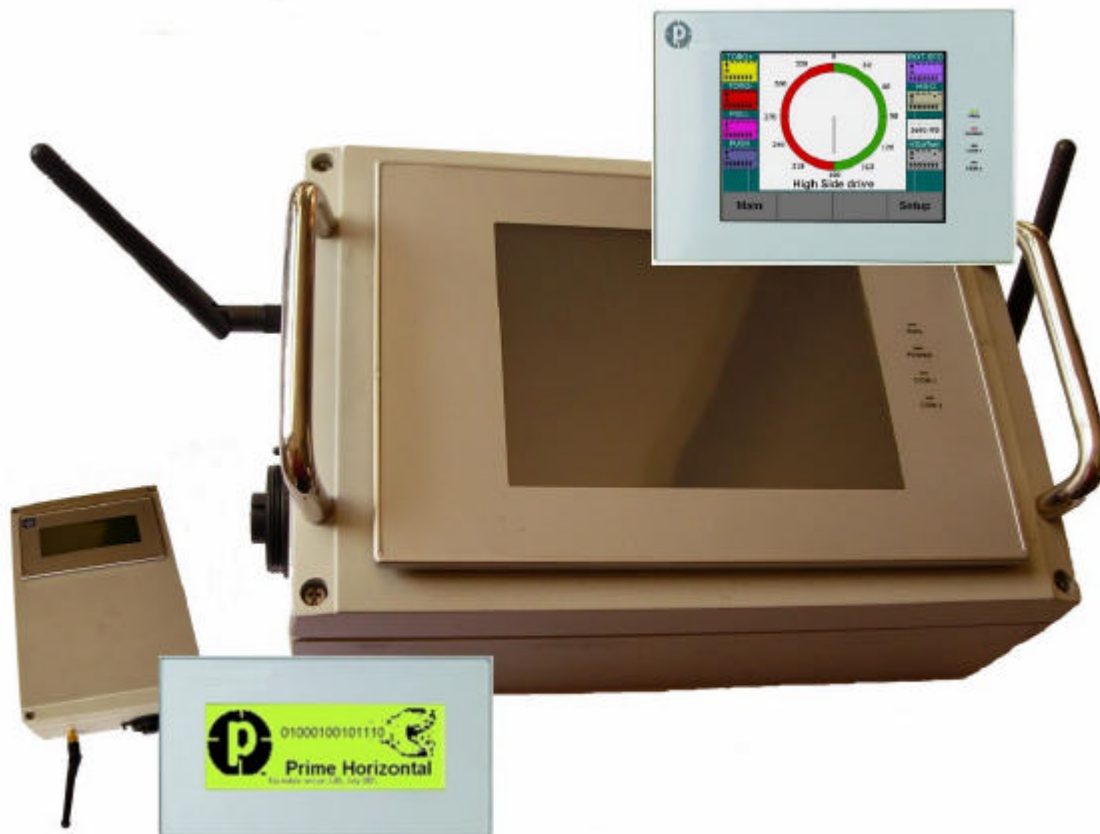

SPECIFICATION AND OPERATING MANUAL FOR HMI LOGGING SYSTEM

CABLE AND/OR WIRELESS HMI LOGGING
SYSTEM, BY PRIME HORIZONTAL B.V.



WARNING: WIRELESS DISPLAY USES LITHIUM POLYMEER RECHARCHABLE BATTERIES!!! USE ONLY RECOMMENDED CHARGERS AND REPLACEMENT BATTERIES.

Prime Logging System manual V1.00, 13 October 2007

SPECIFICATION AND OPERATING MANUAL FOR HMI LOGGING SYSTEM

CABLE AND/OR WIRELESS HMI LOGGING SYSTEM,
BY PRIME HORIZONTAL B.V.

GENERAL DESCRIPTION

Prime Horizontal's Logging System has been developed with the use of several 24Vdc HMI touch screens and analogue/digital IO modules communicating (measuring, storing and transmitting) by cable and/or wireless connections.

The Logging module displays, stores and transmits calibrated data from the Rig module. Future developments will include Mud and Power modules and Survey data.

The Logging module is also capable of transmitting the data by a modem connection to a WWW database by the WITS protocol. Future developments include a satellite connection.

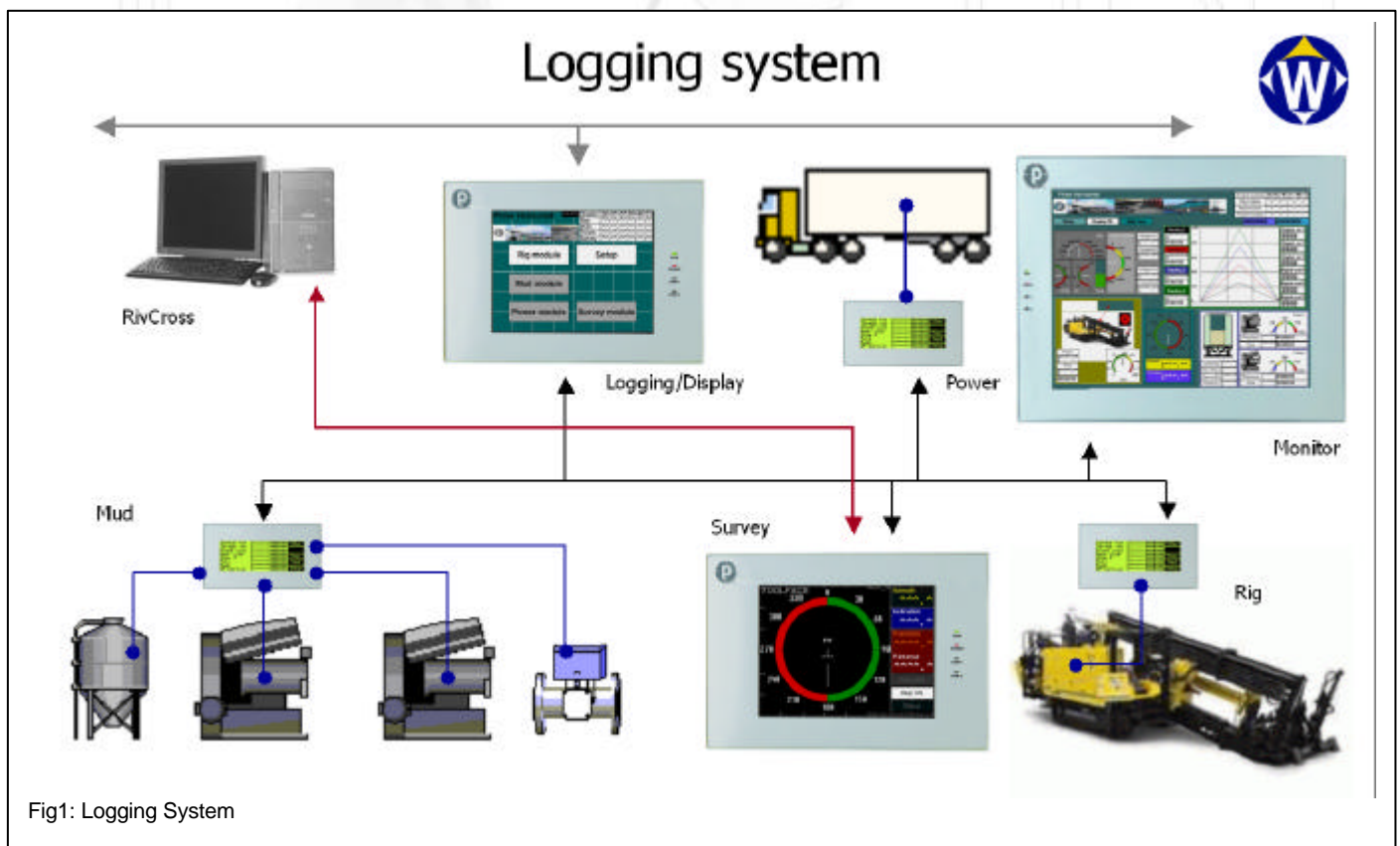

Fig1: Logging System

For more information contact Prime Horizontal at <http://www.prime-horizontal.com>